

# HGAL Series

## Hazardous Location LED Luminaire

### Product Description:

The HGAL Series LED Luminaire can be used in locations made hazardous by the presence of flammable vapors, gases, or combustible dusts as defined by the NEC, Atex, CNEX, and CSA. The HGAL Series is IP66 and IK10 rated. An adjustable U-Bracket and pendant mounting are standard.

### Applications:

- Power Plants / Heavy Industrials Storage Facility
- Paper Mills / Wastewater Treatment Plants
- Loading Docks / Platforms / Shipyards
- Chemical Processing Facility
- Petrochemical Processing Facility
- Mining
- Ocean Marine
- LNG facilities
- Metal Industry

### Features:

- Heavy-duty and high impact resistance.
- Three connection cable entry points.
- Dimmable and non-dimmable options available.
- Emergency battery backup available.
- Tempered glass lens standard.
- Various mounting options include: pendant mount, wall mount, stanchion, hook, or surface mount.
- Standard 120-277V, Available options include: 277-480V
- Operating Temperature:
  - 20 - 80W : -40°C - 50°C (-40°F - 122°F)
  - 100 - 400W : -40°C - 40°C (-40°F - 104°F)
- **Housing:** Copper-free Aluminum
- **Gasketing:** Fluorosilicone Rubber
- **Hardware:** Stainless Steel 304
- **Finish:** Polyester Powdercoat
- **Lens:** Tempered Glass or Polycarbonate
- **LED Chips:** Philips
- **Driver:** Meanwell
- **Surge Protection:** 10KV
- **Expected Life:** Over 85,000 hrs.
- **Rating:** IP66 & IK10
- **Color Rendering Index (CRI):** 80



**EMERGENCY BATTERY BACKUP ONLY  
AVAILABLE FOR 150W-400W**

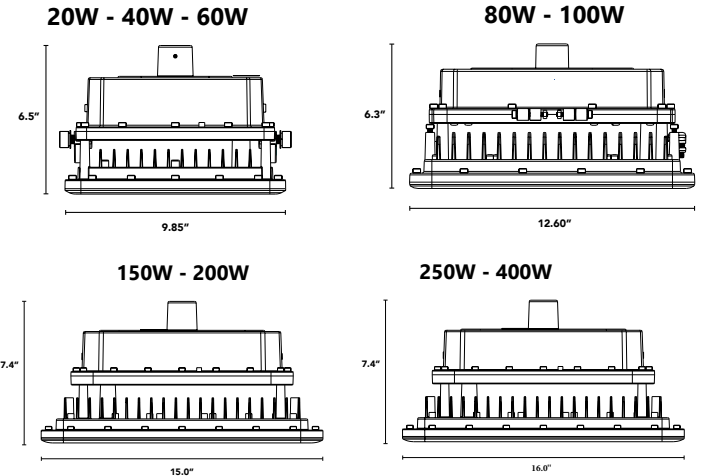

### Compliance

#### UL 844 Hazardous Locations North America

- Class I, Division 2, Groups A, B, C, D
- Class II, Division 1, Groups E, F, G
- Class II, Division 2, Groups F, G
- Class III

#### Marking Atex

- II3 G Ex ec IIC T3C Gc
- II2 D Ex op is tb IIIC T160°C Db
- EX IIC EX mb eb IIC T3C Gb
- II2 EX op is tb IIC T3C Db

#### Marking IECX

- Ex ec IIB T3C Gc
- Ex op is tb IIIC T160°C Db
- EX mb eb IIC T3C Gb
- EX op is tb IIC T3C Db

#### Marking Marine

- UL1598, UL1598A
- ABS

#### Other Markings / Standards

- IP66

## Photometrics

200W/40D

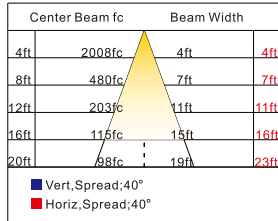

200W/60D

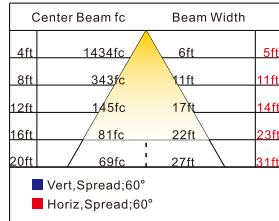

200W/90D

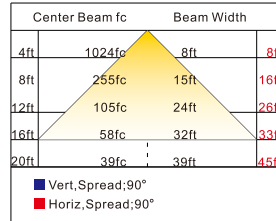

200W/120D

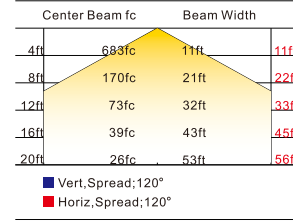

## Lumen Chart

	5000K	5000K
20W	2,700 lm	35,000 lm
40W	5,400 lm	42,000 lm
60W	8,100 lm	40W
80W	10,800 lm	56,000 lm
100W	13,500 lm	
150W	20,250 lm	
200W	28,000 lm	

## Mounting Accessories

OPEB: Junction Box

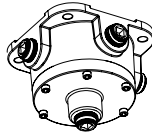

OPWA25: 25° Wall Mount & Junction Box

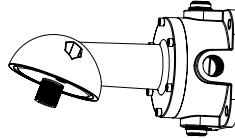

OPWA90: 90° Wall Mount & Junction Box

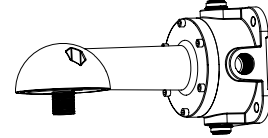

OPWA: 90° Wall Mount

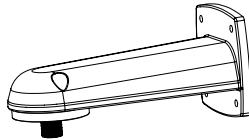

OPPS25: 25° Pole Mount

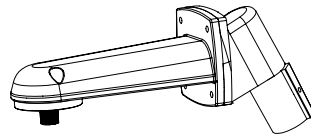

OPPS90: 90° Pole Mount

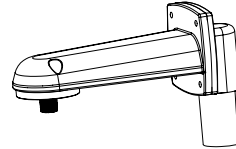

YSP: Slip Fitter to Yoke Adapter



## Ordering Information

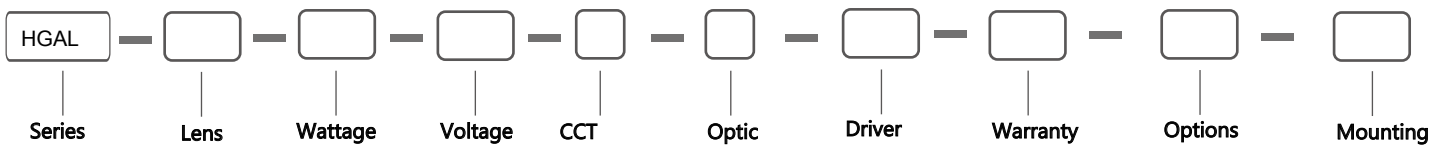

SERIES	LENS	WATTAGE	VOLTAGE	COLOR TEMP	OPTIC	DRIVER
HGAL	G = Glass Lens P = Polycarbonate Lens	2 = 20W 4 = 40W 6* = 60W* 6L* = 60W* 8 = 80W 10 = 100W 12 = 120W	15 = 150W 20 = 200W 25 = 250W 30 = 300W 40 = 400W	A = AC100-277V B = AC200-480V	S = 3000K I = 4000K C = 5000K K = 6000K	M = 40° N = 60° O = 90° P = 120°  EMERGENCY BATTERY BACKUP ONLY AVAILABLE FOR 150W-400W

\*6 (60W) = 10.2x6.3x8.1in  
\*6L (60W) = 12.5x9.45x6.5in

### WARRANTY

5Y = Five Year Warranty  
10Y\*\* = Ten Year Warranty\*\*  
\*\*Please contact factory for 10yr warranty option

### OPTION

EM = Emergency Battery Backup  
S = Sensor  
BAA\*\*\* = Buy American Act Compliant\*\*\*  
TAA\*\*\* = Trade Agreements Act Compliant\*\*\*  
\*\*\*Please contact factory for BAA and TAA options.

### MOUNTING AND ACCESSORIES

OPEB = Junction Box  
OPCM = Ceiling / Surface Mounting & Junction Box: 3/4"  
OPWA = NPT 90° Wall Mount  
OPWA25 = 25° Wall Mount & Junction Box: 3/4" NPT  
OPWA90 = 90° Wall Mount & Junction Box: 3/4" NPT  
OPPS25 = 25° Pole Mount: 1-1/2" NPT  
= 90° Pole Mount: 1-1/2" NPT