

# H201 Series

## Wrap Around Surface Mount Units

### STANDARD



This surface mounted wrap around unit is designed for use in most commercial, residential, and institutional type applications. The unit provides maximum light output with minimum clearance.

### Construction:

- Housing is designed from heavy gauge die formed steel and is finished in baked white enamel or polyester powder coating for maximum durability and reflectivity. Clear acrylic prismatic wrap around diffuser hinges from either side and snaps on and off for easy maintenance.

### Electrical

All units are furnished with UL Listed Class P thermally protected ballast. Other voltages are available upon request. Fixtures meet requirements for UL Luminaire Standard # 1598. All units comply with National Energy Standard. All units are UL certified damp location M 59006648

### Mounting

Unit is equipped with knockouts and holes for pendant or surface mounting. This Fixture can be mounted individually or continuous run.



### WARRANTY & LISTINGS

- 5-year warranty of all electronics and housing.
- UL Certified for damp location M 59006648

### DIMENSIONS

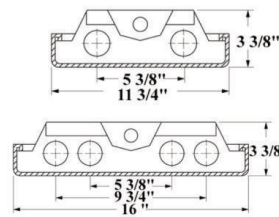

### Fixture Length

T12	T8	T5	Length
F20T12	F17T8	F14T5	24"
F40T12	F32T8	F28T5	48"
F96T12	F96T8	---	96"

### For Tandem Units:

Multiply lamp length above by lamp quantity

Fixture	Bulb Spacing
2 Tube	5 3/8"
4 Tube	2 1/4" - 5 3/8"
2- <del>Tube</del> 4 Tube Housing	7"

max weight= 16lbs/48 32lbs/96"

### Ordering Guide

H2P01

Series	# of Lamps	Lamp Size	Ballast Type	Options
H201	1 = 1 lamp 2 = 2 lamp 3 = 3 lamp 4 = 4 lamp  Tandem One row 21 Tandem two rows 22 Tandem three row 23 Tandem four rows 24	<b>T8</b> 17 = F17T8 25 = F25T8 32 = F32T8 59 = F96T8 86 = F96T8/HO  <b>T5</b> 14 = F14T5 21 = 21T5 28 = F28T5  <b>T5HO</b> 24 = F24T5 39 = F39T5  <b>T12</b> 15 = F15T12 20 = F20T12" 30 = F30T12 40 = F40T12 96 = F96T12 96HO = F96T12/HO	<b>120 = 120V</b> <b>MV</b> = Multivolt <b>E-LW</b> = Electronic .77 BF <b>E-O</b> = Electronic 1.18 BF <b>E-DIM</b> = Dimming Unit  <b>SET LED N</b> = Wired 1 end hot for LED tubes <b>SET LED N/S</b> = Wired 2 ends hot for LED tubes <b>W/LEDIF</b> = LED ballast driven tubes	<b>EMB</b> = emergency ballast <b>2BAL</b> = 2 ballast <b>REFS</b> = Silver Reflector <b>OCC-E</b> = External Occupancy Sensor