

Job Name: _____

Type: _____

Part #: _____

Notes: _____

LSHLEMR16

LED Hazardous Location Emergency Unit

ILLUMINATION

- Two fully adjustable, ultra bright 3.3 watt high performance MR-16 base LED lamp heads for optimized center-to-center spacing.
- 219 Lumens per Head.

ELECTRICAL

- Dual 120/277 voltage.
- Unique bi-color LED indicator light alerts occupant on battery condition (Green-normal, Red-check-battery).
- Charge rate/power "ON" LED indicator light and magnetic test switch for mandated code compliance testing.
- 6V/12V maintenance-free, rechargeable NiCd battery.
- Offers 7.8W of remote capacity (6V/12V DC output) standard
- Internal solid-state transfer switch automatically connects the internal battery to LED lamp heads for minimum 90-minute emergency illumination.
- Fully automatic solid-state, two-rate charger initiates battery charging to recharge a discharged battery in 24 hours.

MOUNTING

- Die-cast mounting brackets provided for surface wall-mount installation.
- Pre-installed conduit hub for conduit and pendant-mount installation.

HOUSING

- Housing is fiberglass reinforced polycarbonate construction in gray finish.
- Corrosion-resistant enclosure with one piece, high-impact resistant, UV stabilized polycarbonate lens and molded gasket with stainless steel screws.

OPTIONS

- SDT: Self-diagnostic feature performs monthly, biannual, and annual tests to ensure reliable operation and meets electrical and life safety codes.
- CW: Optional internal heater and battery blanket for extreme cold temperature applications (-20°C – 50°C).
- TP: Tamper-proof hardware helps discourage unauthorized access to the unit.



DIMENSIONS

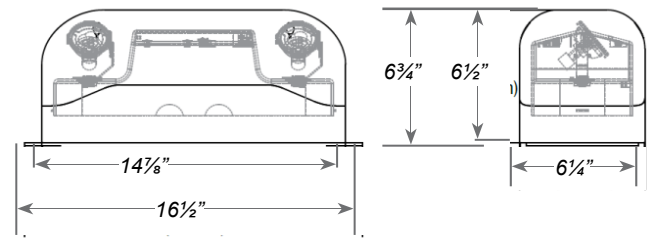

WARRANTY / LISTING

- Five year warranty on all electronics and housing. Batteries prorated for five years.
- Meets UL924, NFPA101 Life Safety Code, NEC, OSHA, Local and State Codes.
- IP66 rated for Ingress protection.
- Rated for Class 1, Division 2, Groups A, B, C & D UL listed for wet locations (0°C – 50°C).

STANDARD



OPTIONAL



Sample Part Number: LSHLEMR1615G

MODEL	BATTERY VOLTAGE		WATTAGE		HOUSING COLOR		OPTIONS	
LSHLEMR16	6	6 Volt	15	15 watts	G	Gray	SDT	Self-Diagnostics
	12	12 Volt					CW	Cold Weather
							TP	Tamper-proof



Job Name: _____

Type: _____

Part #: _____

Notes: _____

REMOTE LAMP COMPATIBILITY

Reference remote lamp head specifications sheets for complete catalog number ordering information.

MODEL NUMBER	BATTERY	REMOTE CAPACITY	RHLED-MV*	SRHLED*	RHLED16
LSHLEMR16	6V, 12V	7.8W	X	X	X

*Not Class 1 Division 2 rated. For use in non-hazardous locations only.

ELECTRICAL INFORMATION

LSHLEMR16 Series Model with Input Voltage Rating	VAC (V)	Hz	Max. Current (A)	Max. Power (W)
6V battery version	120	60	0.12	13.6
	277	60	0.06	16.9
12V battery version	120	60	0.11	12.5
	277	60	0.06	15.1